

**TECHNICAL INFORMATION**

<b>Arrow :</b>	4.8 mm
<b>Category :</b>	Plates
<b>Contact lip diameter :</b>	60 mm
<b>Height (in mm) :</b>	22
<b>Horizontal force :</b>	120.07 N
<b>inner barrel diameter :</b>	8 mm
<b>Mass :</b>	16 g
<b>Number of bellows :</b>	0.5 Bellows
<b>Range :</b>	Suction cup
<b>Series :</b>	VPC
<b>Shape :</b>	Plate
<b>Vertical force :</b>	60.04 N
<b>Volume :</b>	9.14 cm <sup>3</sup>

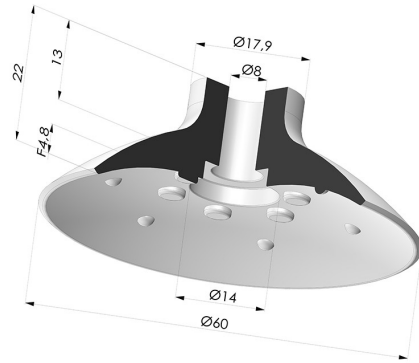

**Variants:**



Variant reference:  
**VPC 60MNT A**

- Color: Bordeaux
- Matter: Non-staining material for plastics processing
- Shore Hardness: SH60



Variant reference:  
**VPC 60SLT A**

- Color: Translucent
- CE food certified
- Matter: Silicone



Variant reference:  
**VPC 60NI A**

- Color: Black
- Matter: Nitrile
- Shore Hardness: SH50

**Related products:**

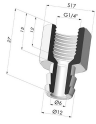

**Separable Female Fitting G1/4"**

Product reference: D



**Separable Male Fitting G1/4"**

Product reference: E

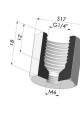

**Adaptor - Female G1/4" - Female M6**

Product reference: F14F6



**Adaptor - Female 1/8G - Female M6**

Product reference: F18F6

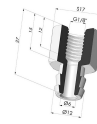

**Separable Female Fitting G1/8"**

Product reference: H

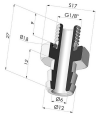

**Separable Male Fitting G1/8"**

Product reference: I



**Crimped Female Fitting G1/4"**

Product reference: L

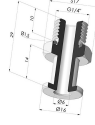

**Crimped Male Fitting G1/4"**

Product reference: M

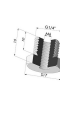

**Adaptor - Male 1/4G - Female M6**

Product reference: M14F6



**Adaptor - Male 1/8G - Female M6**

Product reference: M18F6



**Screw M5 - Head Ø 14 mm - L 20.5 mm**

Product reference: M5



**Screw M6 - Head Ø 14 mm - L 20.5 mm**

Product reference: M6

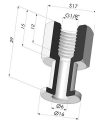

**Crimped Female Fitting G1/8"**

Product reference: R



**Crimped Male Fitting G1/8"**

Product reference: S



**Screw M8 - Head Ø 14 mm - L 20 mm**

Product reference: M8T14L20.5