

MODE D'EMPLOI  
GEBRAUCHSANWEISUNG

SCHÉMA DE PRINCIPE/PRINZIPSHEMA

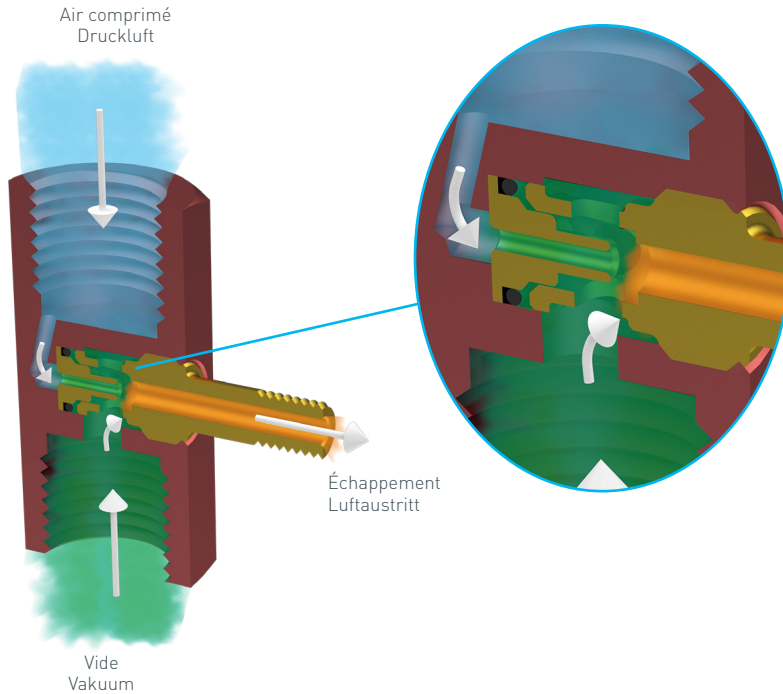

PLAN/PLÄNE

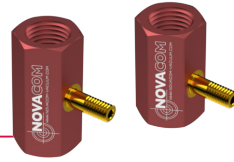
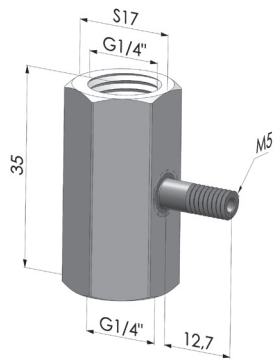

VM1-F14

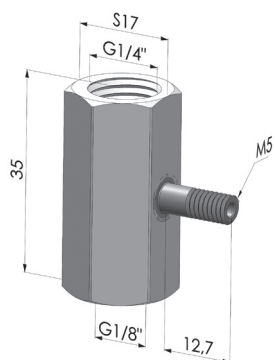

VM2-F18

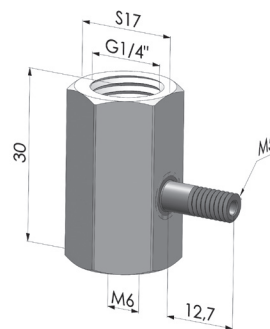

VM3-F6

Référence/ Artikelnr.	Ø Buse/ Düse (mm)	Raccord vide/ Anschluss Vakuum	Air aspiré/Angesaugte Luft à/bei 5 bar			Vide/ Vakuum (%)	Air consommé/ Luftverbrauch (l/min)	Pression d'air/ Luftdruck (bar)	Masse/ Gewicht (g)
			(l/min)	(l/s)	(m³/h)				
VM1-F14	0,7	Femelle G1/4"/IG	14	0,23	0,84	80	21	5	18
VM2-F18	0,7	Femelle G1/8"/IG	14	0,23	0,84	80	21	5	20
VM3-F6	0,7	Femelle M6/IG	14	0,23	0,84	80	21	5	19

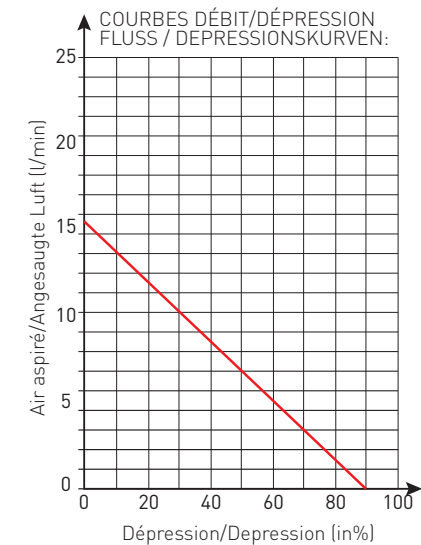
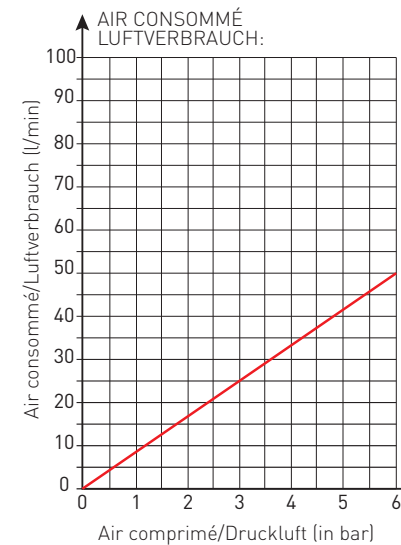
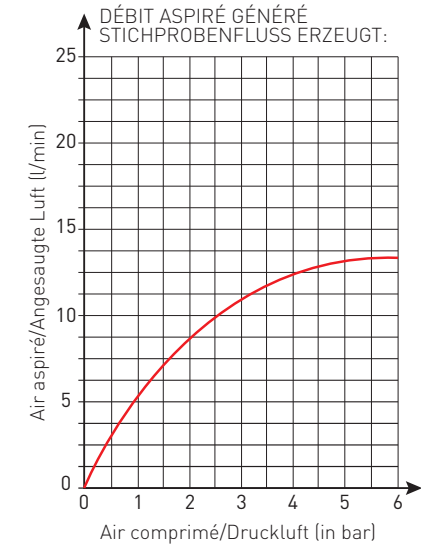
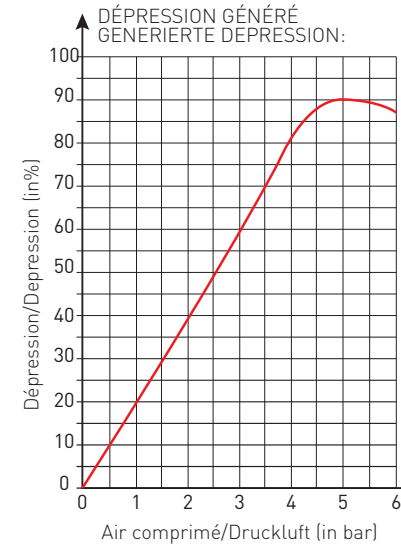

2 possibilités de montage avec silencieux :  
 - Silencieux standard - F18F5 + SIL VT 10  
 - Silencieux débouchant - F18F5 + SIL 18

2 Montagemöglichkeiten mit Schalldämpfern:  
 - Standardschalldämpfer - F18F5 + SIL VT 10  
 - Offener Schalldämpfer - F18F5 + SIL 18

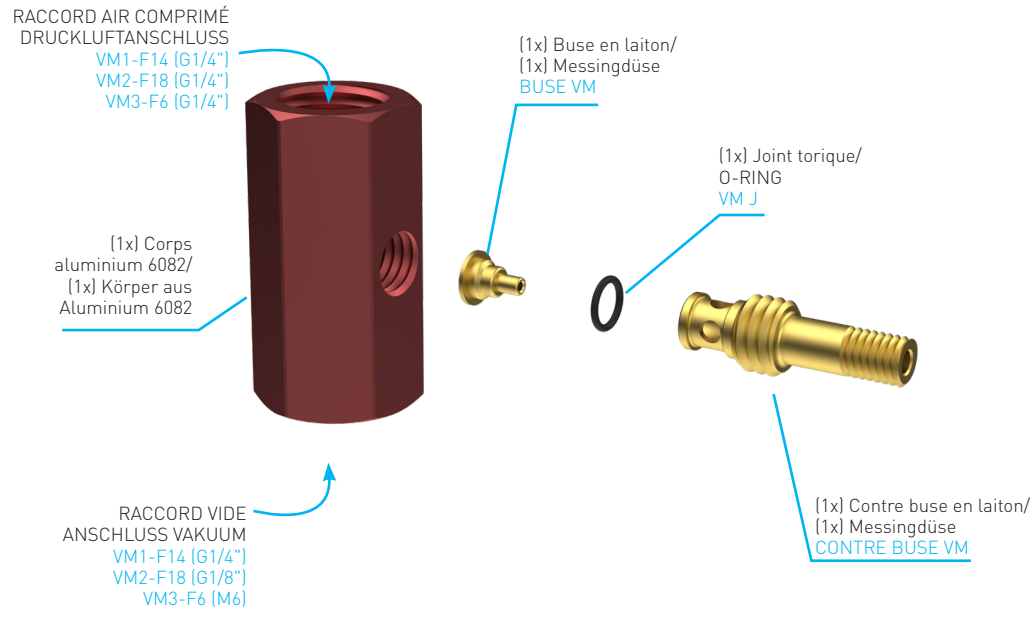
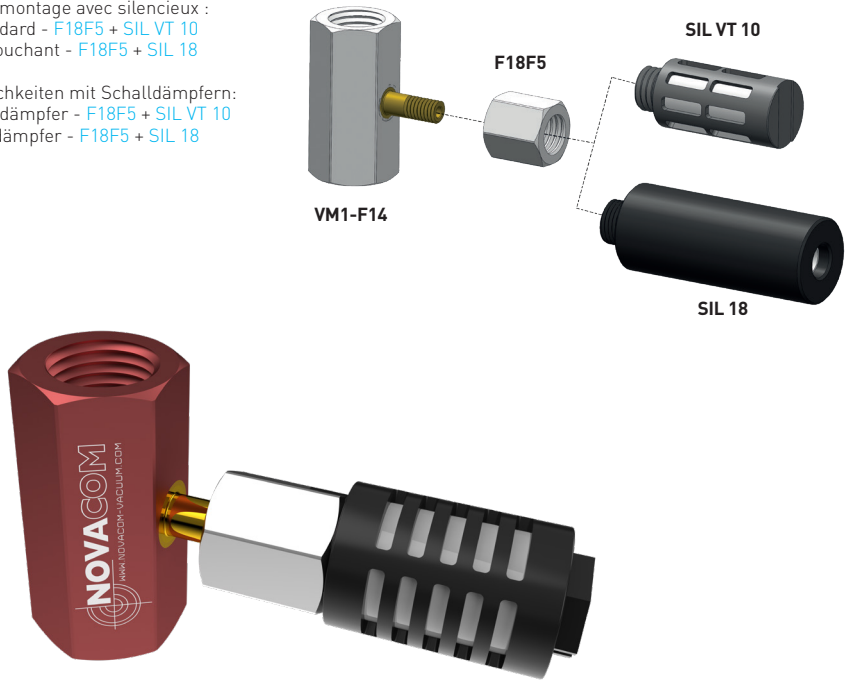

Possibilité d'effectuer un contre-soufflage par l'échappement : 300 055 + 4606 04 05

Möglichkeit des Ableitens des Luftaustritts: 300 055 + 4606 04 05

